



**CUSTOM DASHCOVER INSTALLATION INSTRUCTIONS**

MONO:

INSPECTION:

SEWING:

***Congratulations!***

Thank you for choosing Dash Designs®!

We use Computer Aided Design (CAD CAM) manufacturing for precision patterns, superior workmanship for the best possible fit, and solution dyed fabrics guaranteed not to fade or shrink. If you have any questions installing your Dash Designs® dashcover, don't hesitate to call us first!

**NATIONWIDE: (800) THE DASH (843-3274)**  
**METRO PHOENIX: (480) 967-7829**



**1**

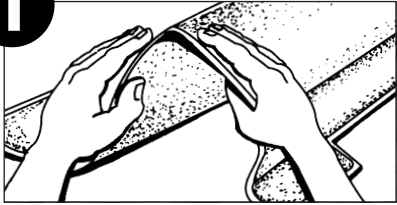

**POSITION DASHCOVER ON DASHBOARD.**

Place your Dash Designs® cover on the dash and PRESHAPE. Bend, fold and crease the material to help conform it to the shape of your dashboard. Use your defroster vents as a guide to line up your dashcover. The warmer the weather, the more your dashcover will conform to the contours of your dash.

\* Ponga el cubridor de tablero sobre el tablero y preforme.

**2**

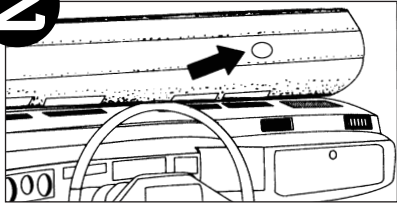

**CHECK FOR SENSOR CUT-OUTS OR MARKINGS.**

Check to see if your vehicle is equipped with automatic headlights, climate control, an alarm sensor or other options which may require a hole to be cut out of your dashcover. This hole may or may not be already cut out. If it is not cut out, check for markings or a perforated hole on the underside of your dash cover. Cut out the opening using a sharp scissors.

\*Inspeccione su tablero por instrumentos de luces/clima o centinelas de crepusculo.

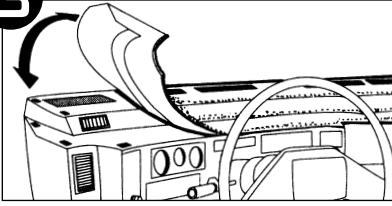
**3**

**NOTE:** Dashboard must be cleaned properly for Velcro® adhesive to adhere properly. Vinyl protectants must also be removed with cleaner for Velcro® to stick.

\* Abroche al tablero utilizando el velcro cosido proporcionado.

## ATTACH DASHCOVER TO DASHBOARD.

Dash Designs® "special hook" Velcro® will stick anywhere to the bottom of carpet or velour dashcovers.

- a) Clean the surface with soap and water or appropriate cleaner.
- b) Cut velcro into 1/ 2" wide strips.
- c) Position tabs as necessary to hold dashcover to dashboard.
- d) Peel the protective paper from each tab and press in place for 10 seconds. Check position while lining up dashcover with defroster vents. Use as many pieces as necessary to hold cover in place.

\* Este seguro que el tablero este limpio.

## Troubleshooting questions

### 1. IS THIS THE RIGHT DASHCOVER FOR MY VEHICLE?

Be sure that the make, model, and yrs. printed on these instructions match your vehicle.

(Note that many vehicles interchange with others and could have the same dashboard and thus would not affect the fit of your cover: Chevy/GMC; Chrysler/Dodge/Plymouth; Lincoln/Ford/Mercury, etc.)

### 2. VELCRO TABS WON'T STICK TO MY DASH.

The Velcro provided will not initially adhere to a dashboard that is too hot, dirty, dusty, or has a vinyl protectant or polish applied. Make sure you are working with a cool, clean surface and clean accordingly. See # 3 at top of this page.

### 3. MY DASHCOVER IS BLOCKING AN AIR VENT/ CLOCK/ASHTRAY, ETC.. OR HANGS OVER THE FRONT EDGE OF THE DASHBOARD.

Make sure your dashcover is aligned with the defroster vents for proper centering. Your Dash Designs® cover may need to be tucked further back between the windshield and the front of the dashboard. A putty knife may be helpful pushing from underneath the dashcover.

### 4. THE FRONT EDGE OF MY DASH DESIGNS® DASH COVER IS WAVY BETWEEN THE WINDSHIELD & DEFROSTER VENTS.

Create tension on both sides of ripples by pulling on dash cover while installing Velcro® tabs.

### 5. MY COVER IS NOT CONFORMING TO THE SHAPE OF MY DASHBOARD.

Be sure to pre-shape your cover (see #1 on front) to achieve a good fit. Give your new Dash Designs® cover a few days to conform to your dashboard. The colder the outside temperature, the longer it may take for your dashcover to conform to the contours of your dashboard.

## Warranty

Dash Designs® guarantees its Foss Fibre® Carpet Dashcovers for the lifetime of the product and its Tritex® 3-Layer Velour Fabric for 5 years: to be free from defects in material and workmanship. In the event of failure, Dash Designs®, Inc. as its only obligation, shall either repair or replace the product at its election and cost. Failure does not include damage due to improper handling during installation, damage from fire, smoke, water or misuse. This warranty does not cover embroidered emblems or lettering. For repair or replacement under the terms of this warranty, return your dashboard cover to your Dash Design® dealer or retailer. Be sure to have a copy of your original receipt. Your retailer may charge you a restocking fee and may not accept returns for: change of color, embroidered covers, or other reasons unique to their establishment. This warranty does not cover damage to other interior components, labor, personal injury or any other damage or injury. This is in lieu of any other expressed or implied warranties. Warranties of merchantability of fitness are excluded.

